

5000 series

L5027CG300E



Features

- The resolution is 2K, the pixel size is 7μm, and the maximum line frequency can reach 44.7K;
- High dynamic range, good signal-to-noise ratio, and excellent image quality;
- Support a variety of image data format output;
- Support multiple ROI, FPN correction;
- Support Gamma, LUT, CCM, automatic black level, Automatic white balance and other ISP functions;
- Support software trigger/hardware trigger/free run and other trigger modes;
- Compatible with GigE Vision V2.0 protocol and GenICam standard;
- Support DC12-24V wide voltage power supply;

Dimensions (mm)

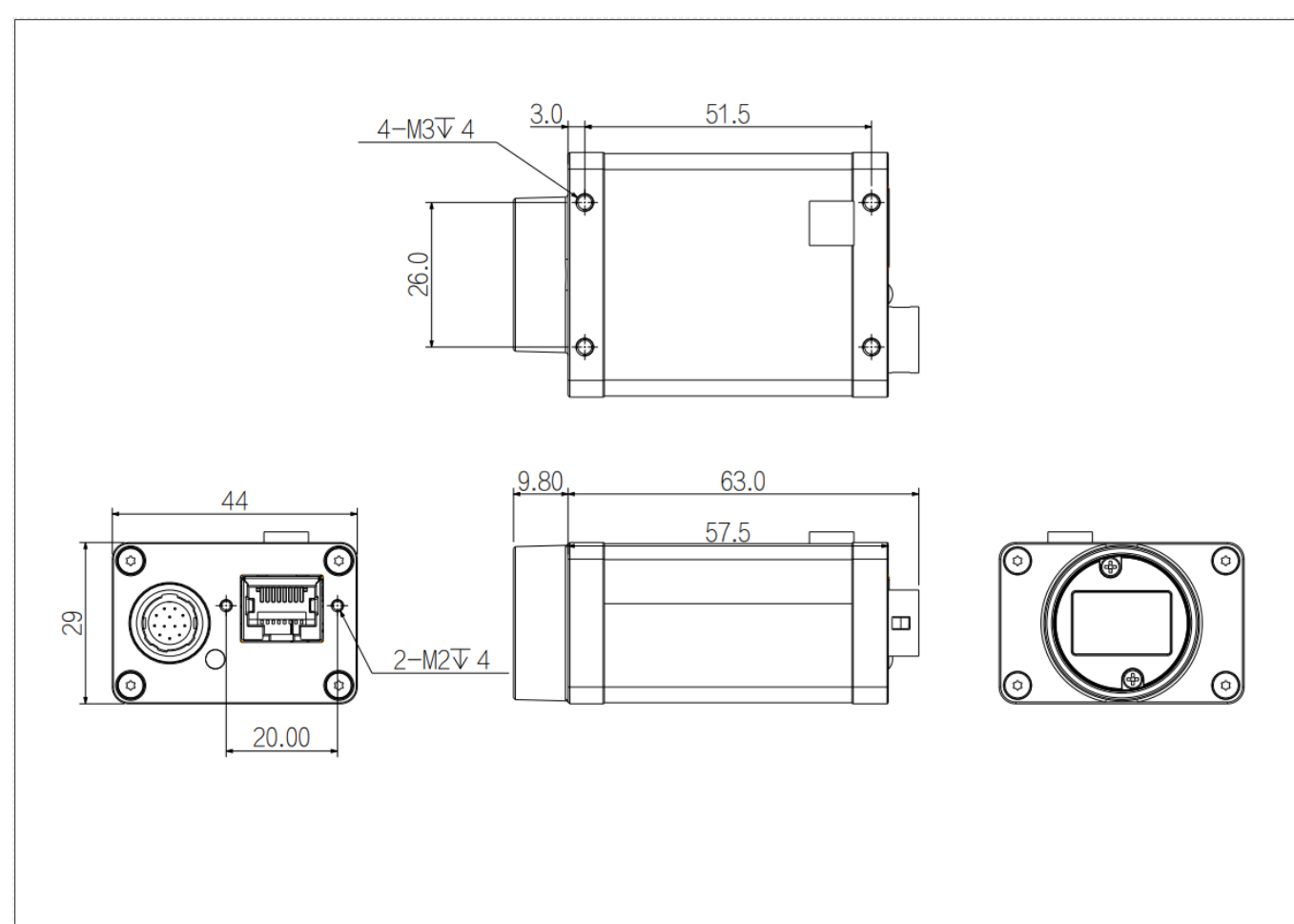

Specification

| | | |
|-------------|-----------------------|--|
| Model | | L5027CG300E |
| Basic | Sensor | 2 K |
| | Image Sensor | Gpixel |
| | Shutter | Global |
| | Resolution | 2048 × 3 |
| | Line Rate | 44.7 kHz |
| | Bit Depth | 12 |
| | Mono/Color | Color |
| | Pixel Size | 7 μm × 7 μm |
| Image | Pixel | 2048 × 3 |
| | S/N Ratio | 39.6 db |
| | Dynamic Range | 65.5 db |
| | Image Format | Mono8/BayerRG8/10/12/10P/12P/RGB8P/YUV422 |
| | Binning | Support |
| | ROI | Support |
| | X Flip | Support |
| | Gain | 1~32 |
| | White Balance | Support |
| | Gamma | From 0 to 4 , support LUT |
| | Exposure Time | 8μS~100mS |
| | Trigger Mode | Software Trigger/Hardware Trigger/Free Run Mode |
| | FPN | Support |
| Performance | User Setting | Support two sets of user-defined configurations |
| | Image Buffer | 64MB Image Cache , 64M Data Cache |
| Port | Port | GigE |
| | GPIO Interface | 12-pin Hirose interface for external power supply and external triggering; 2 differential/single-ended inputs, 1 differential configurable input or output, 1 high-speed optocoupler single-ended input, 1 GPIO configurable input or output |
| | Lens Mount | C-Mount |
| Power | Power Supply | DC12-24V power supply |
| | Power Consumption | 4.6W |
| Structure | Product Dimensions | 29 mm × 44 mm × 57.5 mm (Not including rear case connector) |
| | Net Weight | 100 g |
| Environment | Storage Temperature | - 30℃~+80℃ |
| | Operating Temperature | - 30℃~+50℃ |

Spectrogram

