

# MV-GE2000L

## GigE NIC



## Introduction

MV-GE2000L GigE NIC is a PCI Express ×4 Ethernet adaptor developed based on Intel® chip. It has multiple independent RJ45 connectors and is applicable to PCIe ×4, PCIe ×8, and PCIe ×16 card slots.

## Key Feature

- Supports IEEE 802.3 protocol.
- Adopts multiple independent RJ45 connectors.
- Supports 2U chassis.

## Available Model

- MV-GE2002L
- MV-GE2004L

## Dimension

### MV-GE2002L

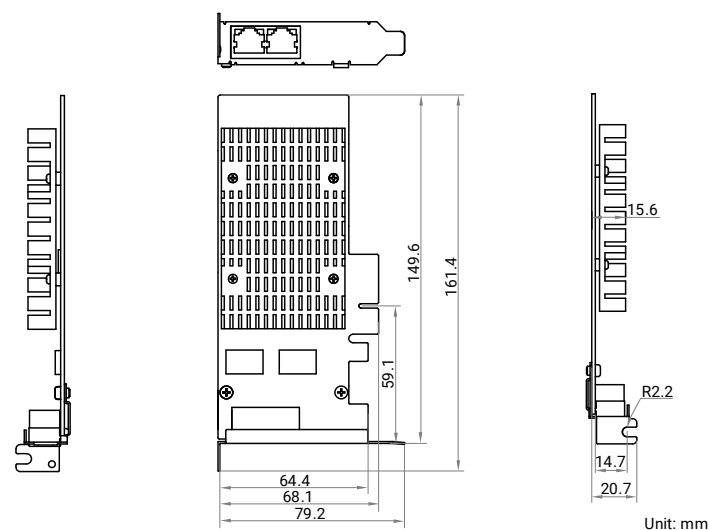

### MV-GE2004L

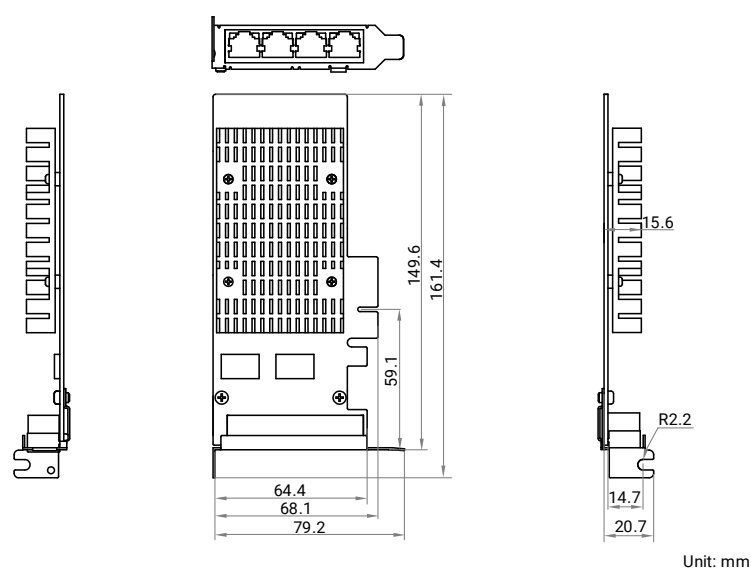

## Specification

Model	MV-GE2002L	MV-GE2004L
Host interface		
Interconnect	PCI-E gen2 × 4	
Delivery bandwidth	860 MB/s (max. transmission bandwidth) 800 MB/s (sustained transmission bandwidth)	
Camera interface		
Standard	IEEE 802.3	
Interface	RJ45 × 2	RJ45 × 4
Camera type supported	GigE industrial camera	
Camera quantity supported	2 at most	4 at most
Camera connection speed	10/100/1000 Mbps	
Stream	2	4
Processing feature		
Jumbo frame	9 KB	
Electrical feature		
Power consumption	Typ. 4.3 W	Typ. 5.5 W
Mechanical		
Dimension	161.4 mm × 79.2 mm × 20.7 mm (6.4" × 3.1" × 0.8")	
Weight	125 g (0.3 lb.)	130 g (0.3 lb.)
Temperature	Working temperature: 0 °C to 60 °C (32 °F to 140 °F) Storage temperature: −30 °C to 70 °C (−22 °F to 158 °F)	
Humidity	10% RH to 95% RH (no condensation)	
Cooling mode	Natural cooling, cooling fins without fans	
General		
Operating system	Windows 7/10/11, Linux	
Certification	CE, RoHS, KC	